

1 September 10, 1980

Introduced by: GARY GRANT
Proposed Ordinance No.: 79-1136

2
3
4
5
6
7
8
9
10
11
12
13
14
15
16
17
18
19
20
21
22
23
24
25
26
27
28
29
30
31
32
33

ORDINANCE NO. 5100

AN ORDINANCE amending King County Zoning Resolution No. 25789, as amended, by amending the Zoning Map, thereof reclassifying certain property thereon at the request of CANYON VIEW ASSOCIATES, Building and Land Development Division File No. 280-79-R.

BE IT ORDAINED BY THE COUNCIL OF KING COUNTY:

SECTION 1. Canyon View Associates petitioned on June 14, 1979, that the property described in Section 3 below be reclassified from B-C and RM-1800 to RM-1800, and this application was assigned Building and Land Development Division File No. 280-79-R.

SECTION 2. The report and recommendation of the Building and Land Development Division was transmitted to the Zoning and Subdivision Examiner on September 20, 1979, and hearing was held by the Examiner on the matter September 27, 1979 and October 23, 1979. The report of the Examiner was filed with the Clerk of the King County Council on April 25, 1980, and the Council approved the reclassification by Motion No. 4879 on May 19, 1980, subject to conditions which will be satisfied per the "P" suffix.

SECTION 3. The legal description of the property to be reclassified is attached as Appendix A and is hereby made a part of this ordinance. The above described property is shown on the attached map which is designated Appendix B and is hereby made a part of this ordinance.

SECTION 4. The King County Council does hereby amend King County Zoning Code, Resolution No. 25789, as amended, by reclassifying that property described and shown in Section 3, Appendices A and B above, to RM-1800-P and directs that Area Map W 11-23-4 be

1 modified to so designate.

2 SECTION 5. This reclassification is granted subject to
3 conditions adopted in Motion No. 4879, and said conditions are
4 incorporated herein as though fully set forth herein.

5 INTRODUCED AND READ for the first time this 4th day
6 of September, 1980.

7 PASSED at a regular meeting of the King County Council
8 this 15th day of September, 1980.

9 KING COUNTY COUNCIL
10 KING COUNTY, WASHINGTON

11 Bill Reams
12 Chairman

13 ATTEST:

14 Dorothy M. Quinn DEPUTY
15 Clerk of the Council

16 APPROVED this _____ day of _____, 1980.

17 DEEMED VALIDATED WITHOUT
18 COUNTY EXECUTIVE'S SIGNATURE.
19 DATED: 9/25/80

20 _____
21 KING COUNTY EXECUTIVE

FILE NO. 280-79-R
APPENDIX A

OVERALL LEGAL DESCRIPTION:

A portion of Tract 153 lying northeasterly of Empire Way South, and lying westerly of the following described line; Beginning at the Southeast corner of said Tract 153, Plat of East Riverton Garden Tracts, Second Addition, according to the plat thereof recorded in Volume 12 of Plats, Page 79, in King County, Washington; thence North $88^{\circ}09'35''$ West 63.61 feet \pm along the south line of said Tract 153 to the point of beginning of said line, thence north $23^{\circ}26'11''$ West 110.59' \pm to the north line of said Tract 153 and the terminus of said line, LESS COUNTY AND STATE ROADS.

A portion of Tract 154 lying northeasterly of Empire Way South, and lying westerly of the following described line; Beginning at the Northeast corner of Tract 154, Plat of East Riverton Garden Tracts Second Addition, according to the plat thereof recorded in Volume 12 of plats, Page 79, in King County, Washington; thence North $88^{\circ}09'35''$ West 150.00 feet \pm along the north line of said Tract 154 to the POINT OF BEGINNING of said line, Thence South $19^{\circ}57'41''$ East 107.70' \pm to the South line of said Tract 154 and the terminus of said line, LESS COUNTY AND STATE ROADS.

5100

FILE 280 - 79 - R
APPENDIX B

Applicant: CANYON VIEW ASSOCIATES

Zone Change: B-C and RM-1800 to RM-1800-P

STR: W 11-23-4



Proposed
Reclassification



"SEE ATTACHED MAPS"

PAGE 1 OF 3

5100

S. 121st. ST.

S. 59th. AVE.

RS-7,200

S. LANGSTON RD.

RS-7,200

59th.

PL.

RS-7,200

SCALE: 1"=200'
280-79-R
PAGE 2 OF 3
SEC. 2 OF 3



S. 57th. AVE.

RS-7,200

I.S.H.

N 10 S

S. R. No. 900

RM-2,400

RM-1,800

56th. AVE. S.

RM-2,400

S. 126th. ST.

RM-1,800

M-H
B.N.
R/W

RM-2,400

EMPIRE WAY S.

RM-1,800-S

B-C

B-C

50th PL. S.

RM-900

B-C

RM-2,400

S. 128th. ST.

S-R

14

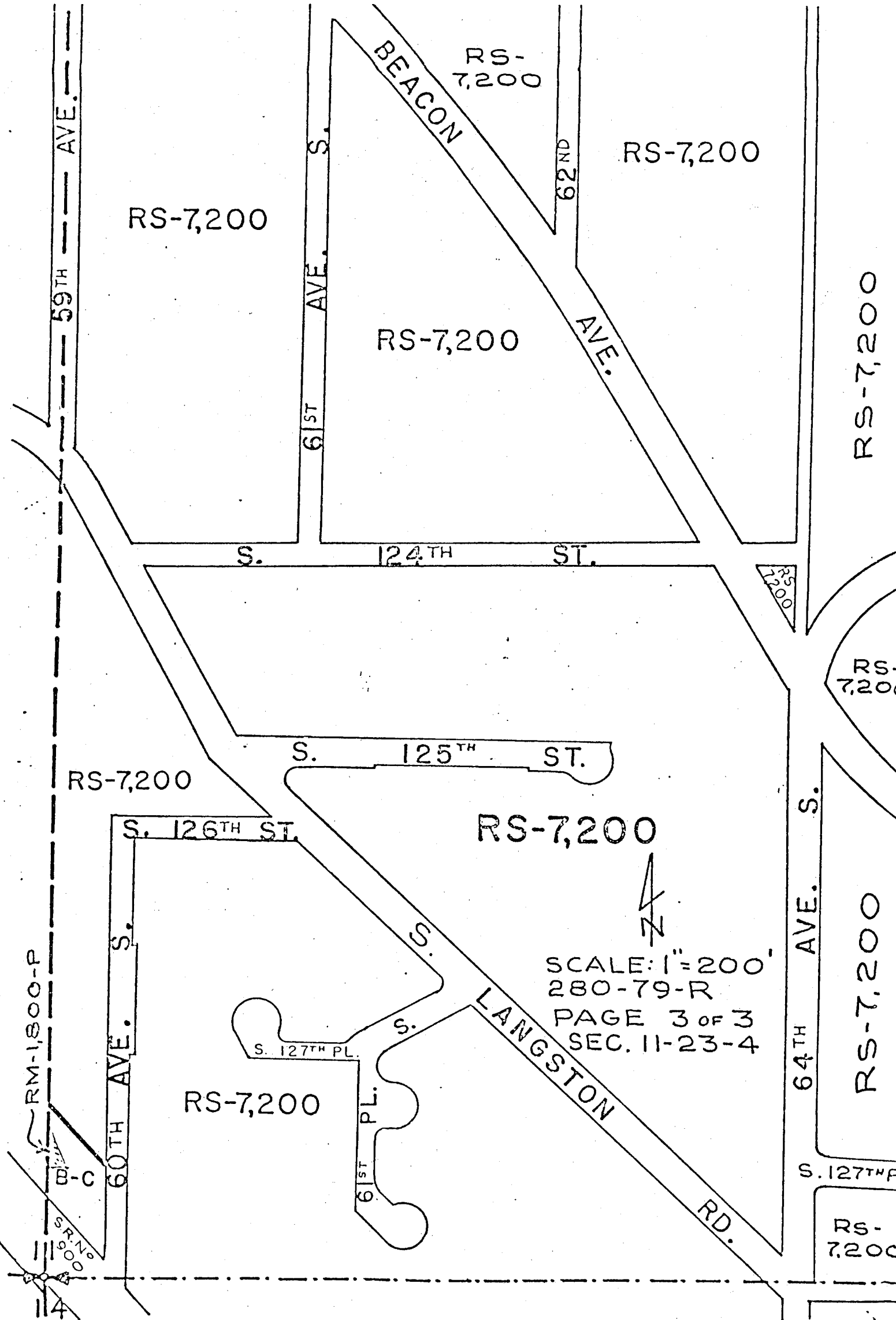

SCALE: 1" = 200'
 280-79-R
 PAGE 3 OF 3
 SEC. 11-23-4

RS-7,200

RS-7,200

RS-7,200

RS-7,200

RS-7,200

RS-7,200

RS-7,200

RS-7,200

RS-7,200

RS-7,200

RS-7,200